



PROPOSED NEW COMMERCIAL DEVELOPMENT  
**GATEWAY SHOPPING CENTER**  
FOR THOMAS GATEWAY LLC  
PINOLE VALLEY ROAD BETWEEN I-40 AND HENRY AVENUE  
PINOLE, CALIFORNIA

Drawn by: checked by: job number:

CONCEPTUAL  
LANDSCAPE  
PLAN

L2

All drawings and notes are subject to engineering review. The engineer shall be responsible for the structural design. The landscape architect shall be responsible for the landscape design. The contractor shall be responsible for the construction.

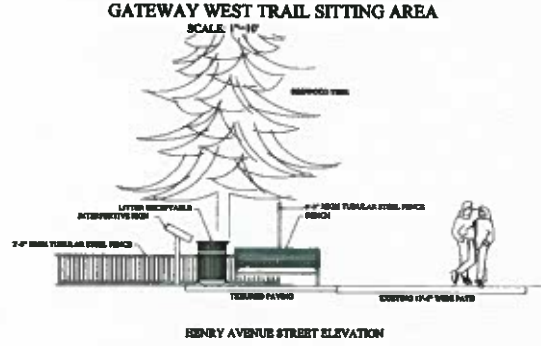
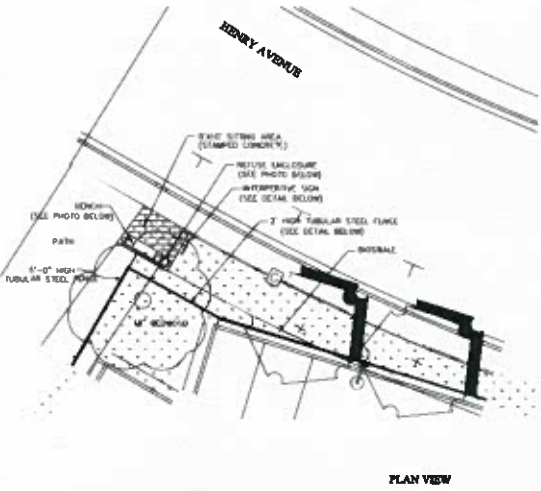
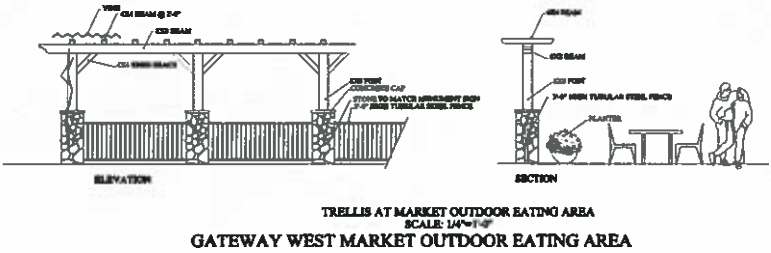
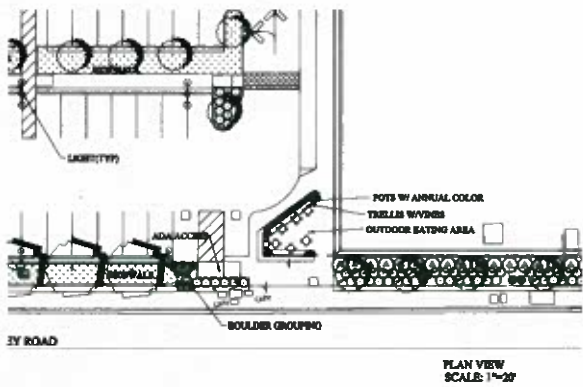
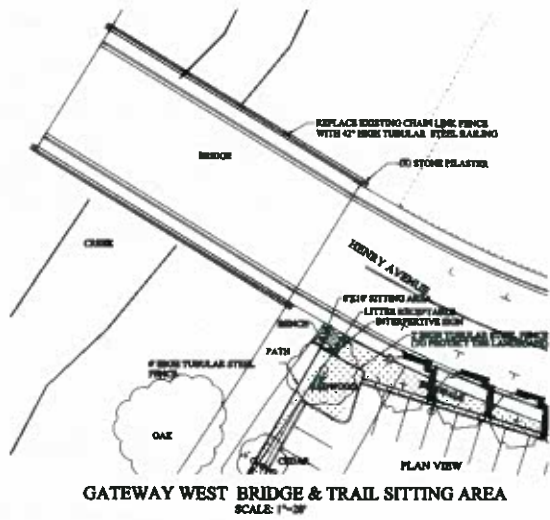
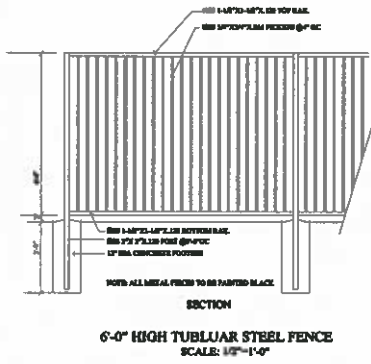
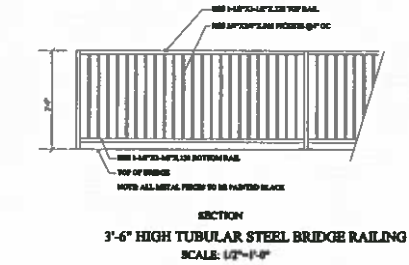

BENCH

SIGN NOTE:  
SEE SIGN DESIGN BOOK FOR ADDITIONAL DETAILS.

NOTE:  
PLAN VIEW DRAWINGS ARE SHOWN AT 1"=20'  
ELEVATION & SECTIONAL VIEWS ARE SHOWN AT 1/4"=1'-0"

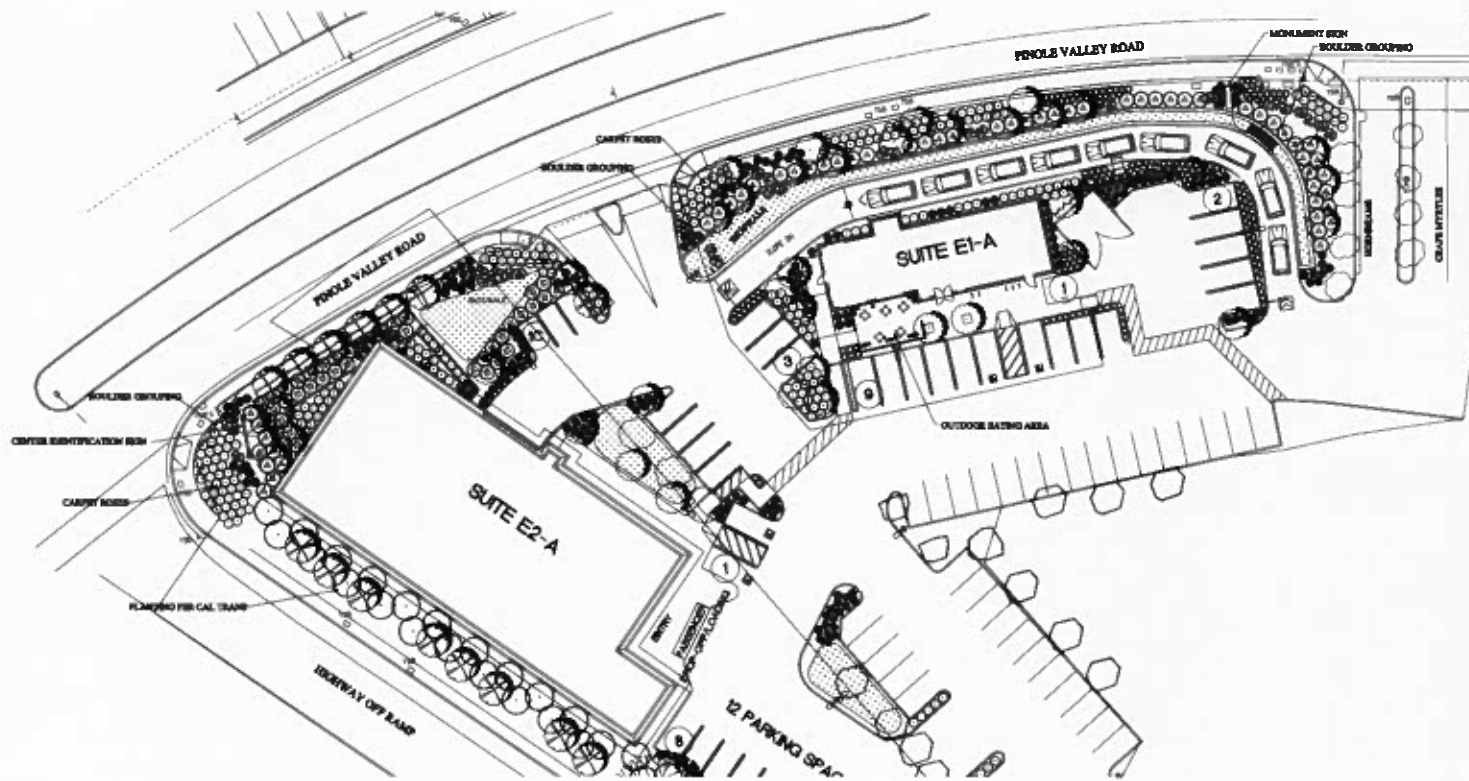

PLAN VIEW



OUTDOOR EATING AT SUITE E1-A



GATEWAY EAST SIGNAGE & LANDSCAPE  
 LOCATED AT THE INTERSECTION OF GATEWAY FOUR OFF RAMP & PINOLE VALLEY ROAD

**SIGN NOTE:**  
 SEE SIGN DESIGN BOOK FOR ADDITIONAL DETAILS.

**NOTE:**  
 PLAN VIEW DRAWINGS ARE SHOWN AT 1/4"=10'  
 ELEVATION & SECTIONAL VIEWS ARE SHOWN AT 1/4"=10'

JAMES SWANSON  
 LANDSCAPE ARCHITECT

5108 - 19 CLAYTON ROAD #100  
 CONCORD  
 CALIFORNIA  
 94608  
 PHONE 925 673 8040

1 DEC 2014

PROPOSED NEW COMMERCIAL DEVELOPMENT  
**GATEWAY SHOPPING CENTER**  
 FOR THOMAS GATEWAY LLC  
 PINOLE VALLEY ROAD BETWEEN H-80 AND HENRY AVENUE  
 PINOLE, CALIFORNIA

CONCEPTUAL  
 LANDSCAPE  
 PLAN

L4